

From the Beginning Sugar Tree the Meanders of the Creek is as follows.

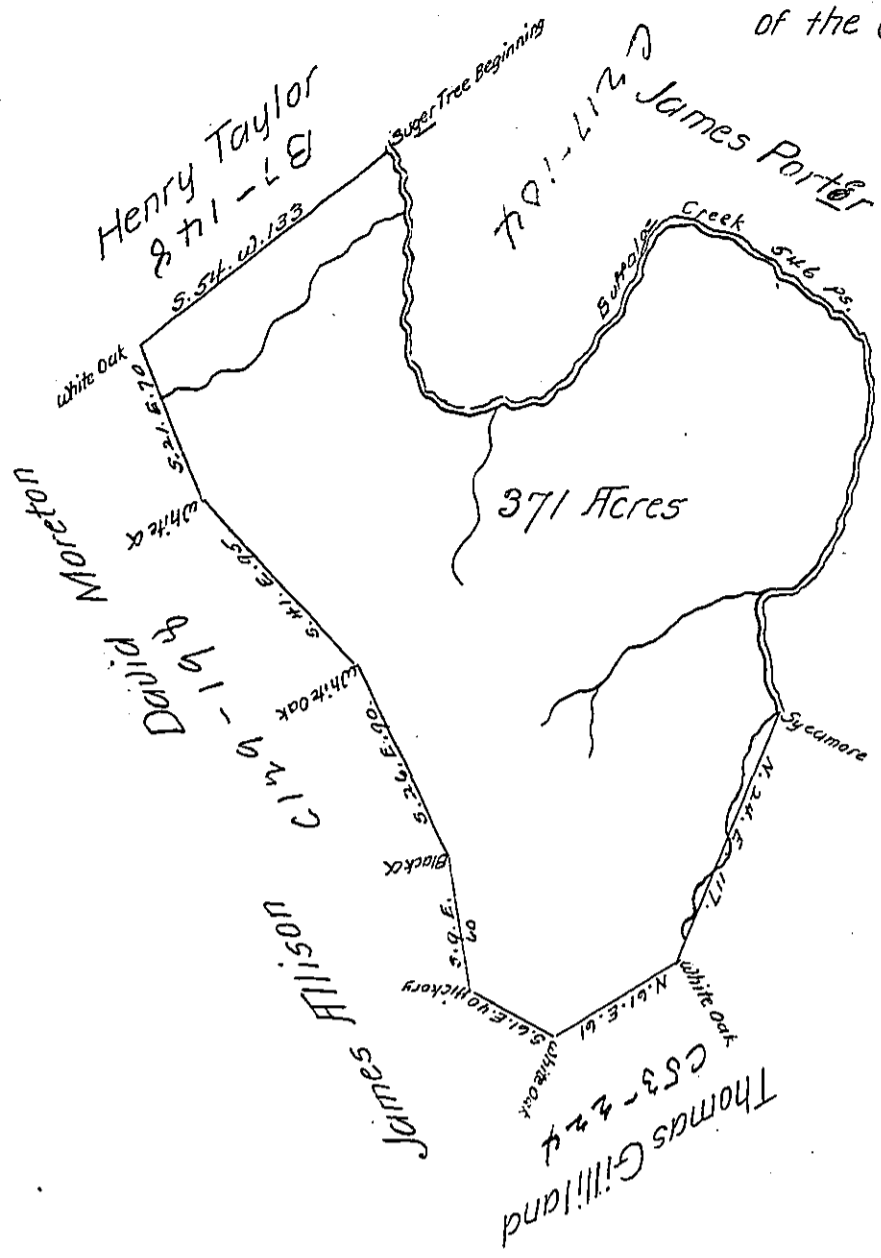

- Charles McRoberts
- North 75
  - N. 27. W. 35
  - S. 87. W. 60
  - S. 40. W. 50
  - S. 13. W. 20
  - S. 33. W. 20
  - N. 73. W. 42
  - N. 50. W. 50
  - N. 18. W. 18
  - N. 8. E. 38
  - N. 28. E. 66
  - S. 66. E. 16
  - N. 8. W. 56 to the sycamore
- 546

The above is a Draught of a Survey made March 12th. 1788 Situate on Buffeloe Creek Called Bear Wallow Containing 371 acres neat measure surveyed In pusuance of a Certificate granted James Caldwell by the Comm<sup>r</sup> of the State of Virginia and entered of Record by Robt. Woods Surveyor of Ohio County on the 20th day of December 1779 as will appear by Relation being had to the same. Entry fd.

Jno. Hoge D.S.

John Lukens Esqr. }  
S. G. State of Penns! }

For John Caldwell

IN TESTIMONY that the above is a copy of the original remaining on file in the Department of Internal Affairs of Pennsylvania, made conformably to an Act of Assembly approved the 16th day of February, 1833, I have hereunto set my Hand and caused the Seal of said Department to be affixed at Harrisburg, this nineteenth day of April 1904.

*Isaac D. Brown*  
Secretary of Internal Affairs.